

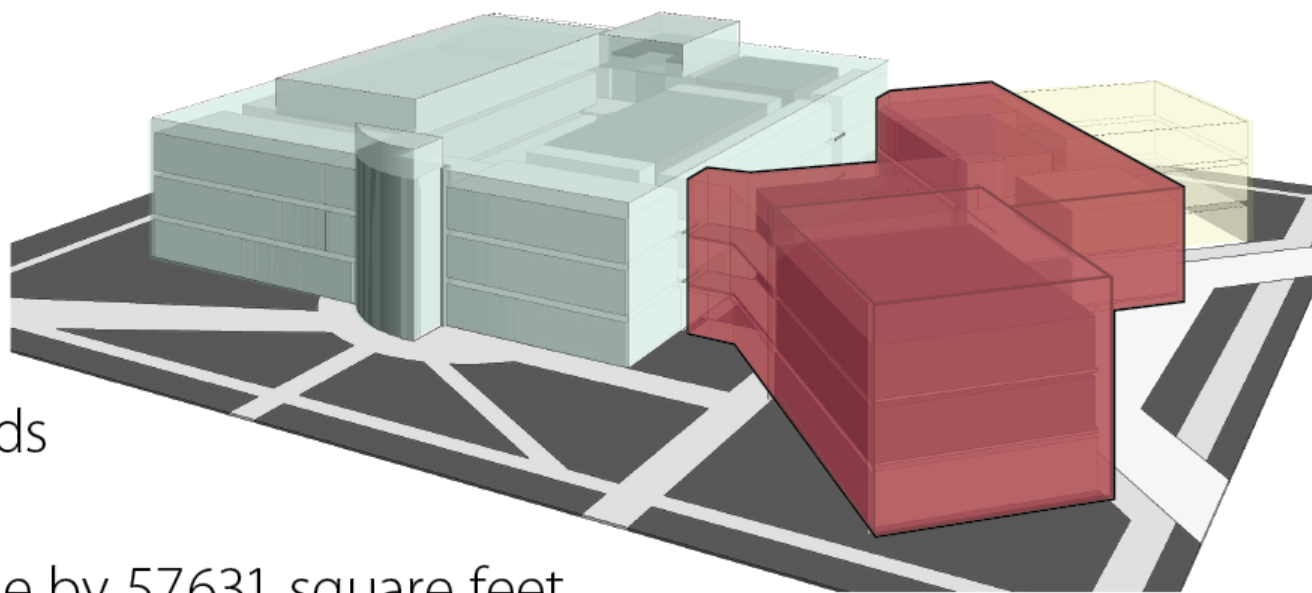

SCHOOL OF HEALTH SCIENCES

NEW BUILDING IMPACT:

- Creating a contemporary space that accommodates additional students
- Increasing enrollment
- Expanding most programs
- Meeting state workforce demands
- Reducing campus square footage by 57,631 square feet



PROJECTED ENROLLMENT GROWTH

20%	↑	Physician Assistant
56%	↑	Dental Hygiene
30%	↑	Nursing
>100%	↑	Medical Laboratory Science
29%	↑	Social Work
29%	↑	Addiction Counseling & Prevention



UNIVERSITY OF
SOUTH DAKOTA



UNIVERSITY OF
SOUTH DAKOTA

SANFORD SCHOOL OF MEDICINE

STUDENTS:

- ▶ SSOM's internal medicine residency program ranked first in performance scores out of 500 internal medicine residency programs in the United States.
- ▶ In FY19, 836 students applied to the school; 207 were granted interviews. Seventy-one students matriculated, all of whom have South Dakota residency status or strong South Dakota roots. Students came from 65 different South Dakota high schools.
- ▶ 80 percent of graduates plan to practice in South Dakota after residency
- ▶ All medical students are required to take the national Step 1 and Step 2 boards. For the current senior class, 100% passed both step 1 and step 2 on their first attempt.
- ▶ The new family medicine residency program in Pierre is fully operational with two residents. Residents do their first year in Sioux Falls and their final two years in Pierre. Later this year, the next class will enter and there will be four residents in Pierre.

SANFORD SCHOOL OF MEDICINE

RESEARCH:

- ▶ Active research programs focus on neuroscience, virology and the molecular basis of disease. Research is increasingly interdisciplinary, with medical scientists working collaboratively across colleges and universities.
- ▶ In FY19, SSOM garnered \$16.1 million in external grants and contracts, \$13.8 million from federal funds.

FACULTY:

- ▶ Approximately 2,000 South Dakota physicians teach SSOM students.



UNIVERSITY OF
SOUTH DAKOTA



UNIVERSITY OF
SOUTH DAKOTA

SANFORD SCHOOL OF MEDICINE

FRONTIER AND RURAL MEDICINE PROGRAM (FARM):

- ▶ Eleven students train for nine months in a rural area. Applicants exceed slots.
- ▶ Sites include Milbank, Mobridge, Parkston, Pierre, Spearfish, Vermillion and Winner.
- ▶ 10 of the 25 FARM students (40%) of graduates have matched in family medicine (versus 9% nationally)





UNIVERSITY OF
SOUTH DAKOTA

SANFORD SCHOOL OF MEDICINE

GRADUATES

98TH

PERCENTILE FOR PROPORTION
OF GRADUATES PRACTICING IN
RURAL AREAS

98TH

PERCENTILE FOR THE
PROPORTION OF GRADUATES
WITH MILITARY SERVICE

98TH

PERCENTILE FOR PROPORTION
OF GRADUATES WHO ARE
NATIVE AMERICAN

TOP 10 NATIONALLY

IN RETAINING STUDENTS WHO
DO BOTH MEDICAL SCHOOL AND
RESIDENCY IN SOUTH DAKOTA